

GLASIMO[®]

PROJECTS



find us on



MINI-CATALOGUE
ALL-GLASS
BALUSTRADES

www.glasimo.eu

Side-mounted

U-PROFILE



PROFILE 4 / CHAMBER PROFILE 4



Top-mounted

Ud-PROFILE



UL-PROFILE / UL-CHAMBER PROFILE

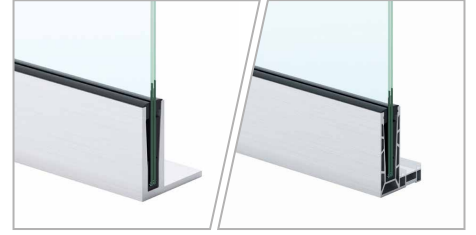

A glass balustrade is mounted in an aluminium profile, which is the only element that fixes the glass. Classic elegance, stability and durability – these are the features distinguishing this type of balustrades.

Aluminium profile ensures mounting of all-glass balustrades to the reinforced concrete base. It can be used for private and public buildings in the range of top rail load-bearing capacity from 0.5 to 3 kN.

Glass with the specified thickness of 66.2, 88.2, 1010.4, 1212.4 can be used for the balustrade profile. Glass is selected depending on the utility requirements of the building.

Aluminium profiles are suitable for indoor and outdoor installation. The static strength analyses conducted in accordance with PN-EN standards confirm its good strength performance and ensure safe use.

★ PREMIUM PRODUCTS ★

Modern design elements

Novelty on the market



Digital Print

Digital printing with vitreous enamel on glass

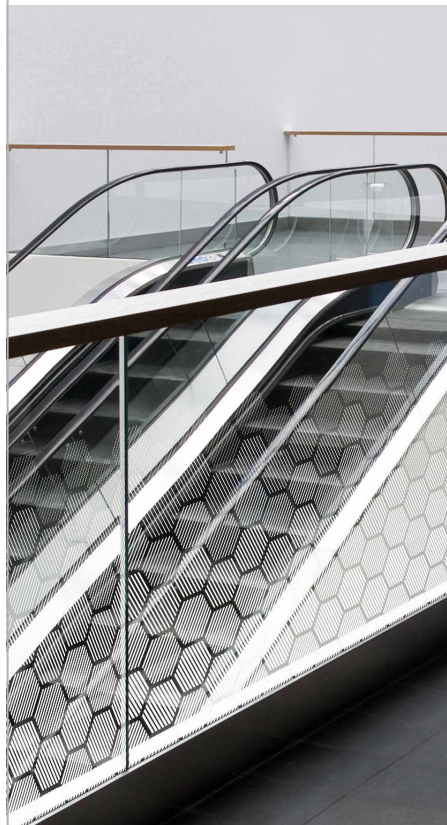

SentryGlas foil

Safety and resistance of laminated glass

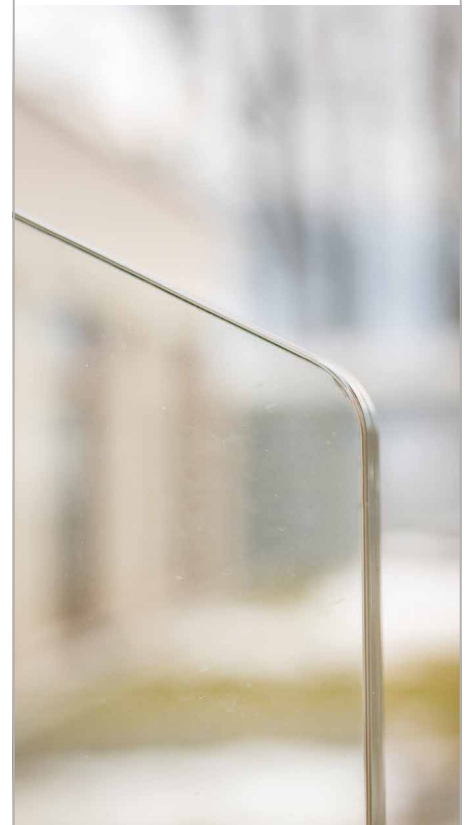



U-PROFILE

CHARACTERISTICS



LOAD	GLASS THICKNESS	LENGTH	WEIGHT	MATERIAL	SURFACE
0.5 - 1.0 kN/m	12,76 mm - 21,52 mm	3000 mm / 6000 mm	Approx. 6.17 kg	Aluminium EN AW-6063	Anodised: natural; black*; brush finish

*available on request

INSTALLATION ACCESSORIES



Set of seals and washers



Cover cap



Edge protection



Railing



Trimming service

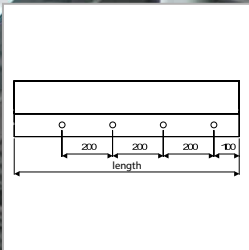
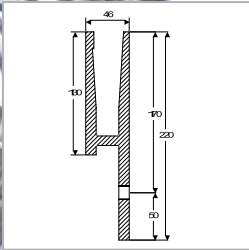

CHARACTERISTICS



LOAD	GLASS THICKNESS	LENGTH	WEIGHT	MATERIAL	SURFACE
0.5 - 1.5 kN/m	12,76 mm - 21,52 mm	3000 mm / 6000 mm	Approx. 10.06 kg	Aluminium EN AW-6063	Anodised: natural; black*; brush finish

*available on request

INSTALLATION ACCESSORIES



Set of seals and washersvv

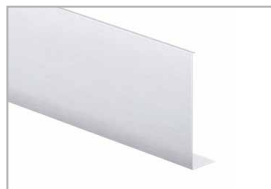

Cover cap



Edge protection



Railing



Trimming service

NEU AUF DEM MARKT

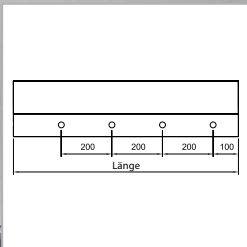
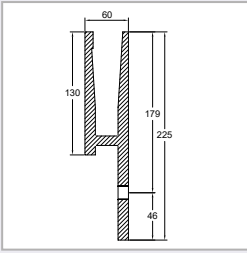

BELASTUNG BIS 3 kN/m

SYSTEM ZUR EINSTELLUNG DER GLASSCHEIBE

KAMMERPROFIL 4

EIGENSCHAFTEN



BELASTUNG	GLASSTÄRKE	LÄNGE	MATERIAL	OBERFLÄCHE
3 kN/m	16,76 mm – 25,52 mm	6000 mm	Aluminium EN AW-6063	Anode: naturell; schwarz*; gebürstet*

*nur auf Anfrage

MONTAGEZUBEHÖR



Kompletter Satz mit Dichtungen und Unterlegscheiben

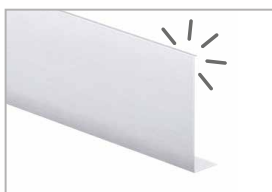

Verblendung mit Einrastverschlüssen



Randschutz*



Reling*



Zuschnittsdienst

*In Kürze erhältlich für Glas 1212.4

*In Kürze erhältlich für Glas 1212.4

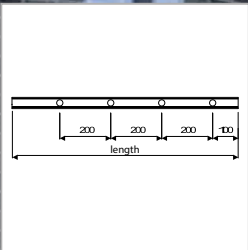
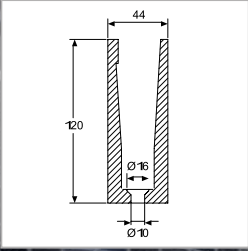

CHARACTERISTICS



LOAD	GLASS THICKNESS	LENGTH	WEIGHT	MATERIAL	SURFACE
0.5 - 1.0 kN/m	12,76 mm - 21,52 mm	3000 mm / 6000 mm	Approx. 6.17 kg	Aluminium EN AW-6063	Anodised: natural; black*; brush finish

*available on request

INSTALLATION ACCESSORIES



Set of seals and washers



Edge protection



Railing



Trimming service

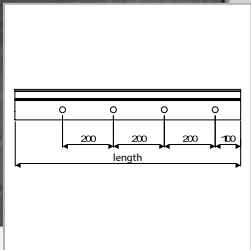
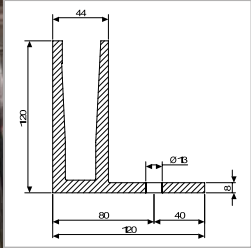

UL-PROFILE

CHARACTERISTICS



LOAD	GLASS THICKNESS	LENGTH	WEIGHT	MATERIAL	SURFACE
0.5 - 1.5 kN/m	12,76 mm - 21,52 mm	3000 mm / 6000 mm	Approx. 8.35 kg	Aluminium EN AW-6063	Anodised: natural; black*; brush finish

*available on request

INSTALLATION ACCESSORIES



Set of seals and washers



Edge protection



Railing



Trimming service

NEU AUF DEM MARKT

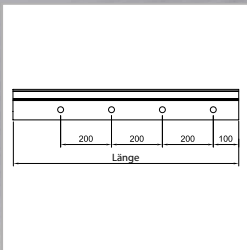
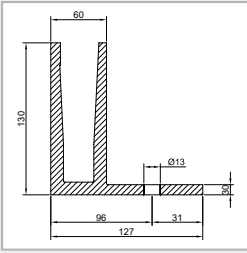

BELASTUNG BIS 3 kN/m

SYSTEM ZUR EINSTELLUNG DER GLASSCHEIBE

UL-KAMMERPROFIL

EIGENSCHAFTEN



BELASTUNG	GLASSTÄRKE	LÄNGE	MATERIAL	OBERFLÄCHE
3 kN/m	16,76 mm – 25,52 mm	6000 mm	Aluminium EN AW-6063	Anode: naturell; schwarz*; gebürstet*

*nur auf Anfrage

MONTAGEZUBEHÖR



Kompletter Satz mit Dichtungen und Unterlegscheiben

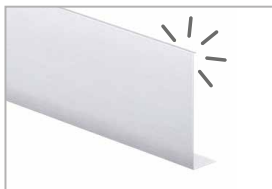

Verblendung mit Einrastverschlüssen



Randschutz*

*In Kürze erhältlich für Glas 1212.4



Reling*

*In Kürze erhältlich für Glas 1212.4



Zuschnittdienst